

DARTINGTON

SOLAR GARDEN LIGHT

USER GUIDE



Ensure your solar panel is South facing or as near as possible



Clean your solar panel from time to time



Do NOT place your solar panel in shaded areas.



Do NOT charge behind glass

Thank you for choosing the Dartington Solar Garden Light. Please read these instructions carefully before using your light.

Important notes

To allow the battery to reach full capacity, pull out the plastic tab and place in full sunlight for the first 12 hours, where possible. Failure to do so can shorten the battery life or performance of the light.

To protect the glass from damage, do not use force against the glass and hold only using the metal parts that connect together. Keep the glass safe in the packaging, until you need to install it.



Installation

Please do not throw away any of the packaging until all parts are verified as present. Please carefully consider where you wish to install your light before making alterations to your property. It's particularly important that the solar panel receives as much sunlight as possible. Ensure that it is not obstructed by buildings, fences, trees, sheds, etc, or the shadows that these create. **If the solar panel is installed in a poor location, it may not perform to the best of its ability.**

Assembly

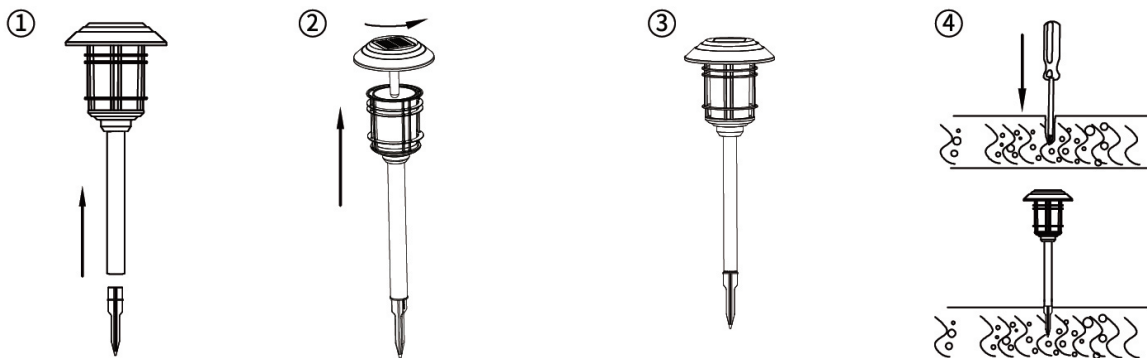

How to use

You will locate the ON/OFF switch on the underside of the light fitting, next to the lightbulb.

Mode 1: Powersaving Mode **[Best for Winter]**

Mode 2: Full brightness

Battery Information

- Do not use alkaline, standard (carbon-zinc) or NiCd (nickel cadmium) batteries.
- Only use AA 1.2V 1000mAh NiMH rechargeable batteries (included).
- Performance will be reduced under adverse weather conditions of extreme cold, extreme heat and humidity.
- Do not open, short circuit or damage the battery as it may result in injury. The battery must be recycled or disposed of properly.
- If you are replacing the battery, please ensure you have the correct size and grade of battery.
- Clean the battery contacts prior to installing the battery.
- If you are not intending to use the product for an extended period of time, we advise you to remove the battery from the equipment.

Troubleshooting

Please ensure that there are no nearby light sources shining on the solar panel after dark. These could be bright indoor/outdoor lights from your property or neighbours, or streetlights.

If you are unsure, take the light inside and test it in a dark room indoors.

If you are encountering any problems with your Dartington, often you can resolve this yourself by following our troubleshooting guide. If the light has its solar panel in a poor location it will struggle to work, but that doesn't mean there is a fault with the unit. Please remember that the light will arrive with some charge and will likely work for a few days even if the solar panel is poorly located. Please try the troubleshooting tips below before contacting your retailer:

Recharge Procedure

1. Double check the location of your solar panel to ensure it is in a clear location and as South facing as possible.
2. Turn the light off at the switch and leave it to recharge for 3-5 days ensuring one sunny day has passed.
3. After 3-5 days return to the Dartington and turn it back on at the switch.
4. If your light still does not illuminate after dark, please contact your retailer.

Maintenance

Clean the surface of the solar panel and light lens with a soft, slightly moistened cloth. Do not use corrosive cleansing agents or chemical solutions as these may damage surfaces and impair operation. Keep the solar panel free of dirt, debris and snow.

Safety Instructions

The Solar Centre assumes no liability for any damage resulting from the use of this product, nor do we assume liability for any damage to property or personal injury caused by improper use or failure to observe these instructions.

Unauthorised conversion and/or modification of the unit may be dangerous and will invalidate your warranty. To avoid damage to sight, do not look directly at the light source. This device is not a toy and should be kept out of reach of children. Do not submerge the device in water or expose it to extreme temperatures (less than -25°C or higher than 50°C).

For customer support please contact:

The Solar Centre Ltd
44-46 Coldharbour Lane
Harpenden
Hertfordshire
AL5 4UN

T: 01727 743200
W: solarcentre.co.uk
E: info@solarcentre.co.uk

