

Installation

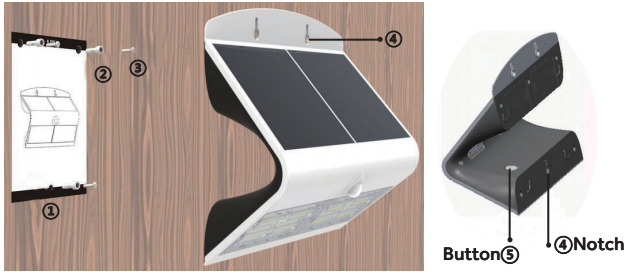

1. Please use the card to measure hole position correctly and drill 3 holes of $\Phi 6\text{mm}$.
2. Fix 3 expansion plugs and fix the lowest screw into the expansion plug leaving the screw proud.
3. Offer up the lamper up the lamp ensuring the screw head enters the rear of the lamp.
4. Insert the notch to the lower screw and fasten the whole lamp well.
5. Press the button to select your preferred working mode. (See section 3)

Notice

1. This is a solar powered lamp, a poor installation location will result in poor performance from your lamp
2. The lamp will light up automatically at dusk.
3. Please note the lighting time will depend on the weather and the installation.
4. Built-in intelligent circuit with over-charge, over-discharge and over-voltage protection.

Warning

1. The lamp is equipped with an internal replaceable rechargeable lithium batteries.
2. If the batteries are taken out & put back in or replaced with new ones, please ensure the solar panel is subject to sunshine or a strong light to activate the lamp.
3. Please do not disassemble the lamp.
4. Please recycle batteries where possible.

V-LIGHT ELITE SOLAR SECURITY LIGHT



EN62471 REACH CE    

Please read and follow all instructions to operate.
Save this manual for future reference.

3 Working Modes

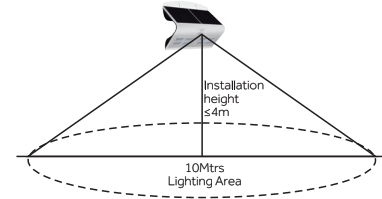
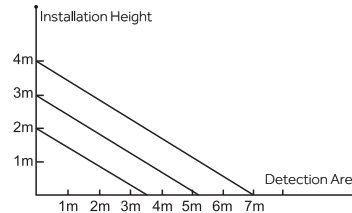

Pls press the Button to adjust to different working mode:

Press 1st time for Mode A. Press 2nd time for Mode B.

Press 3rd time for Mode C. Press 4th time for off.



Mode A: Automatically turns on at the dusk (<30lux) and remains 20% bright, up to 5 hours after which it turns off.



Mode B: Automatically turns on to full brightness when motion is detected in the range ≤ 6 mtrs and then turns to 3% brightness in 20 seconds of no motion.



Mode C (strongly recommended for winter): Automatically turns on to full brightness when motion is detected in the range ≤ 6 mtrs and then turns off in 30 seconds of no motion.